



**JUSTIÇA FEDERAL DE 1ª INSTÂNCIA  
SEÇÃO JUDICIÁRIA DE PERNAMBUCO**

AV. RECIFE, 6250 – JIQUIÁ – RECIFE/PE  
CEP:50781-000 FONE: 3229.6000 FAX: 3229.6115

**PRÉDIO SEDE JFPE**

JUSTIÇA FEDERAL DE PRIMEIRO GRAU EM PERNAMBUCO

PROJETO:  
2º PAVIMENTO DO EDIFÍCIO SEDE

AUTOR DO PROJETO:  
LEONARDO JOSÉ FINIZOLA DE VASCONCELOS

RESPONSÁVEL TÉCNICO:  
CARLOS MAURÍCIO JORDÃO D'OLIVEIRA

DESENHOS:  
- MOBILIÁRIO DAS COPAS

CLIENTE:  
JUSTIÇA FEDERAL EM PERNAMBUCO

DATA:  
28/08/2023

DESENHO:  
LEONARDO VASCONCELOS

FRANCHA Nº:  
11/11

ESCALA:  
1/25

INFORMAÇÕES:

CONFERRIR COTAS NA OBRA

**LEGENDA:**

- PONTO SIMPLES DE TOMADA (2P+T) 220V h=0,30m
- PONTO DÚPLO DE TOMADA (2P+T) 220V h=0,30m
- PONTO SIMPLES DE TOMADA (2P+T) 220V h=1,10m
- PONTO DÚPLO DE TOMADA (2P+T) 220V h=1,10m
- PONTO DE REDE LÓGICA RJ45
- PONTO DE INTERRUPTOR

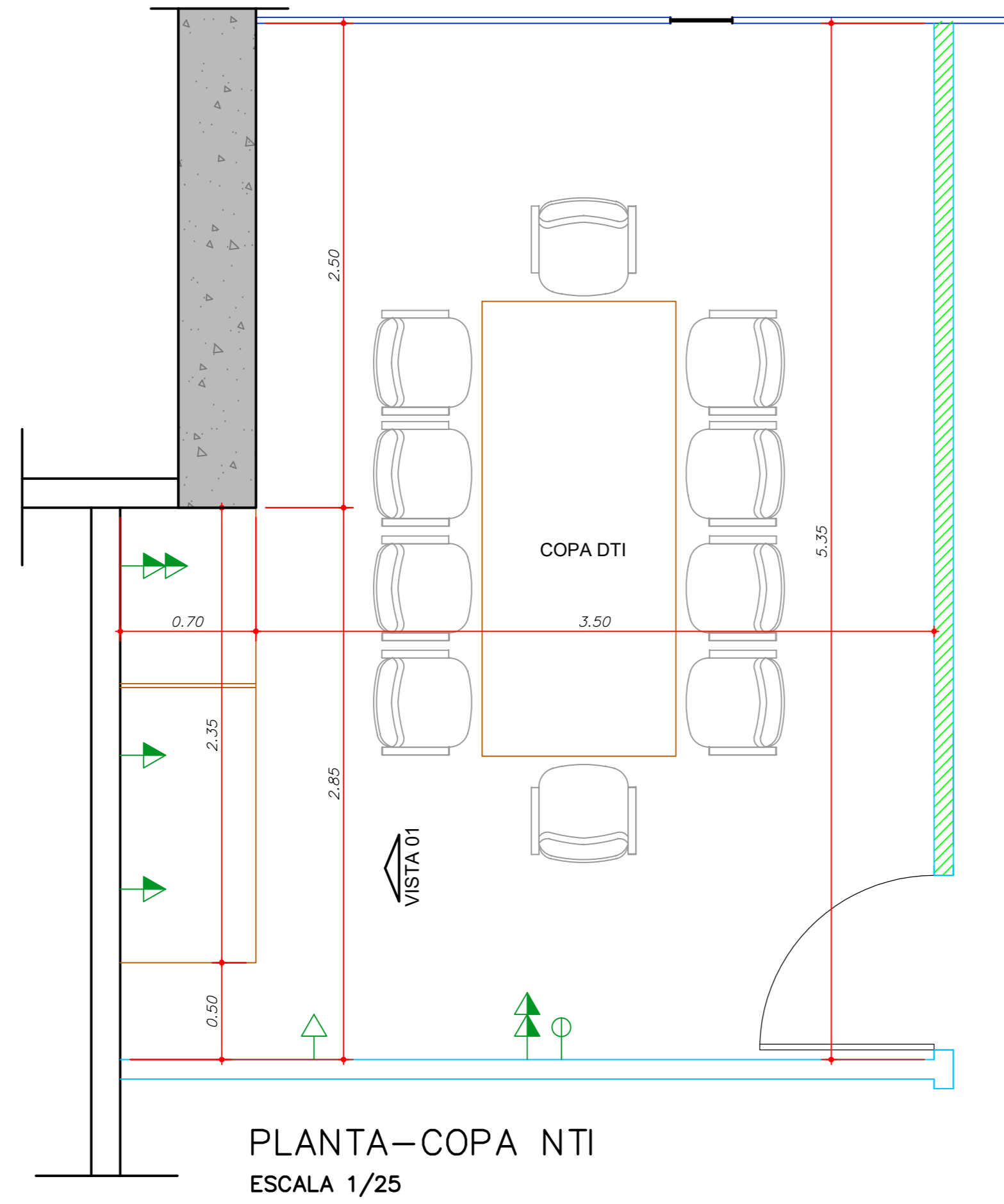

PLANTA-COPA NTI  
ESCALA 1/25

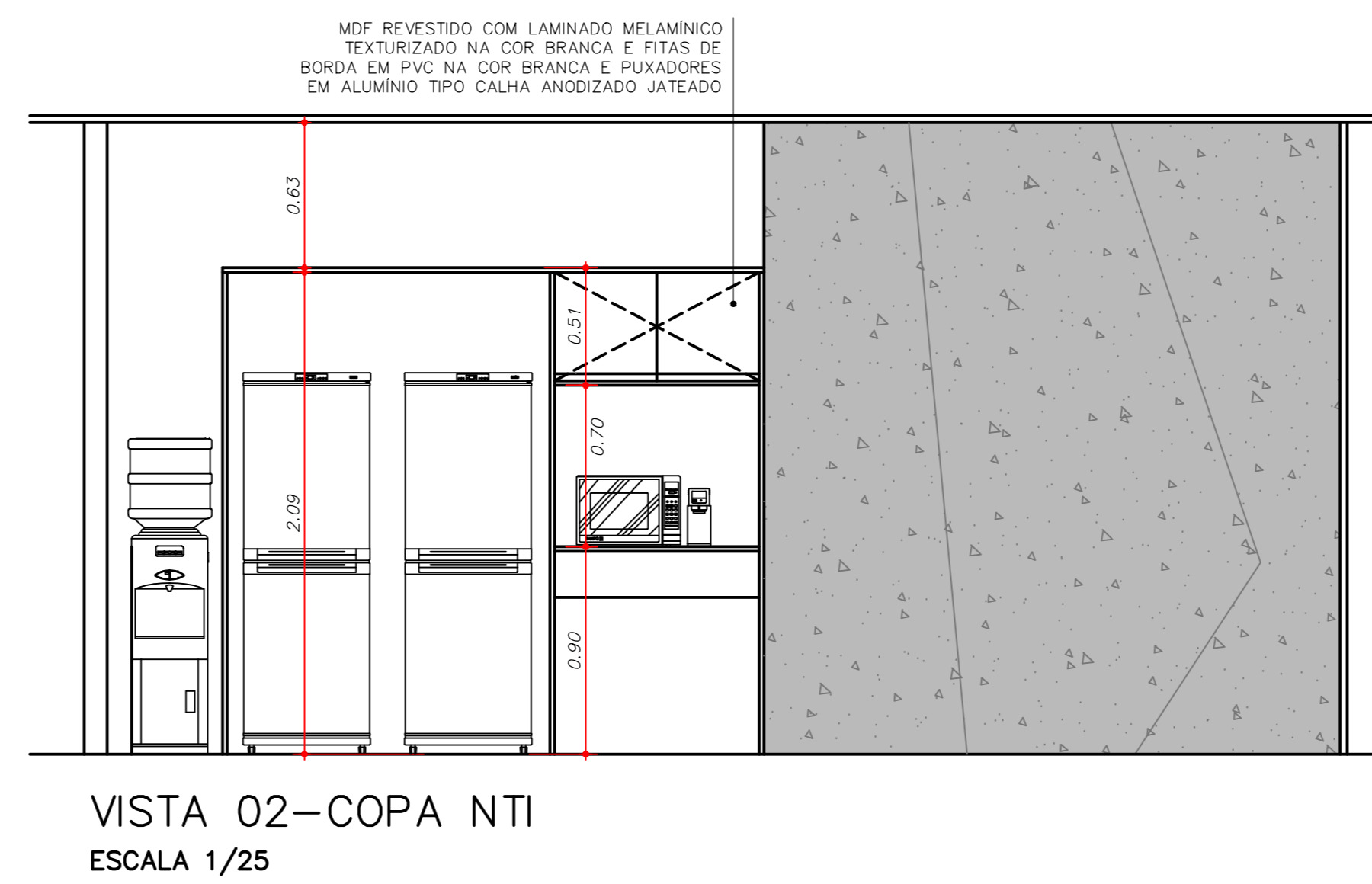

VISTA 02-COPA NTI  
ESCALA 1/25

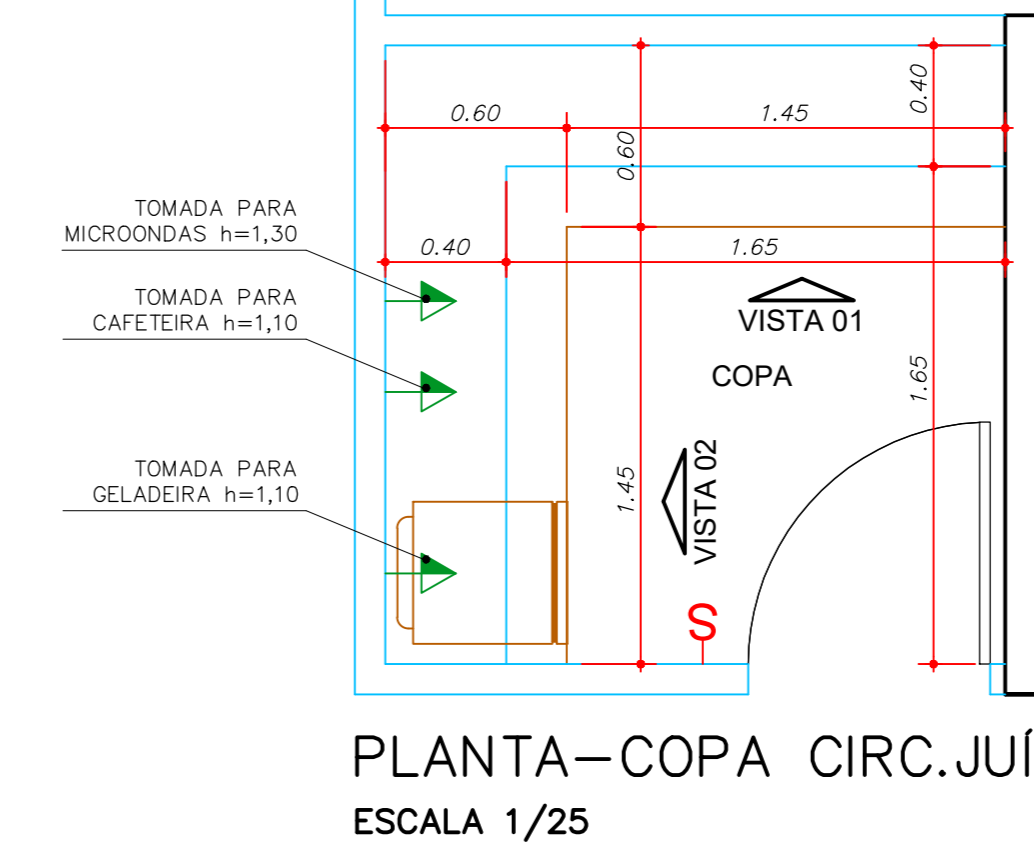

PLANTA-COPA CIRC. JUIZ  
ESCALA 1/25

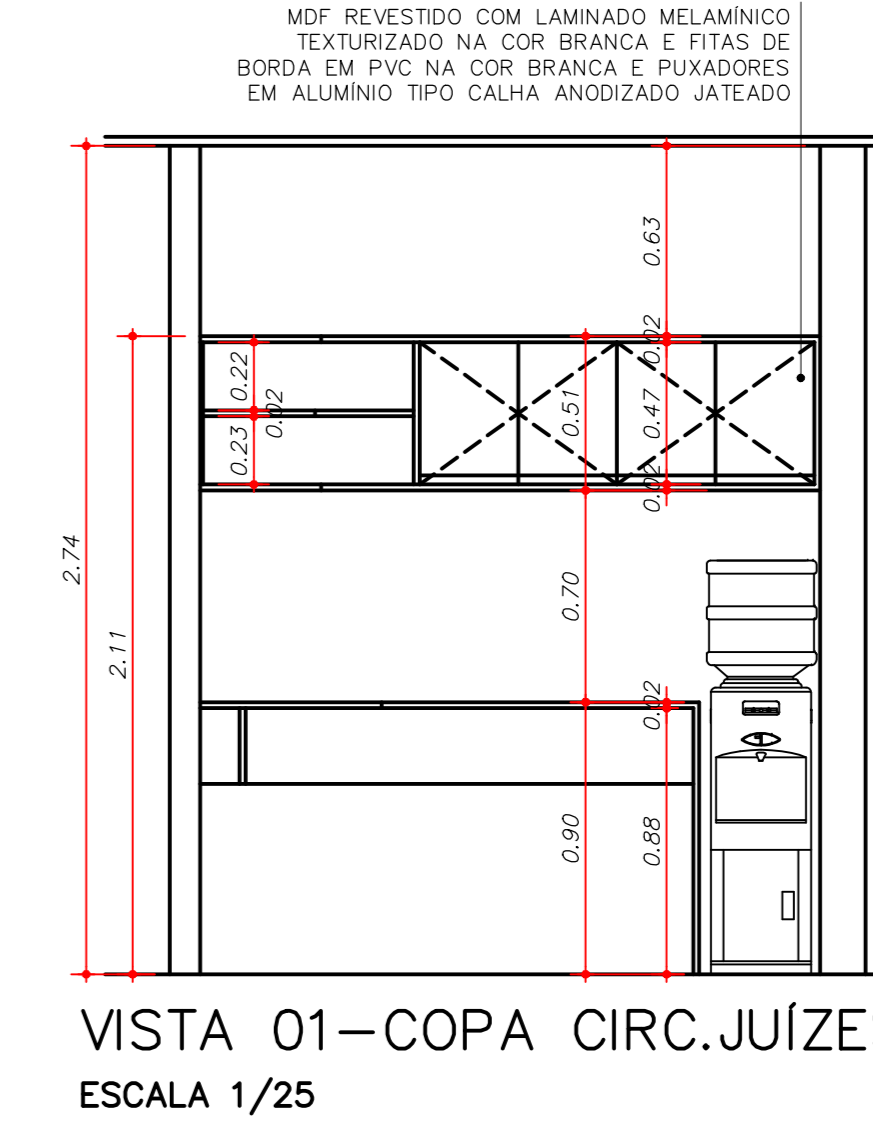

VISTA 01-COPA CIRC. JUIZES  
ESCALA 1/25

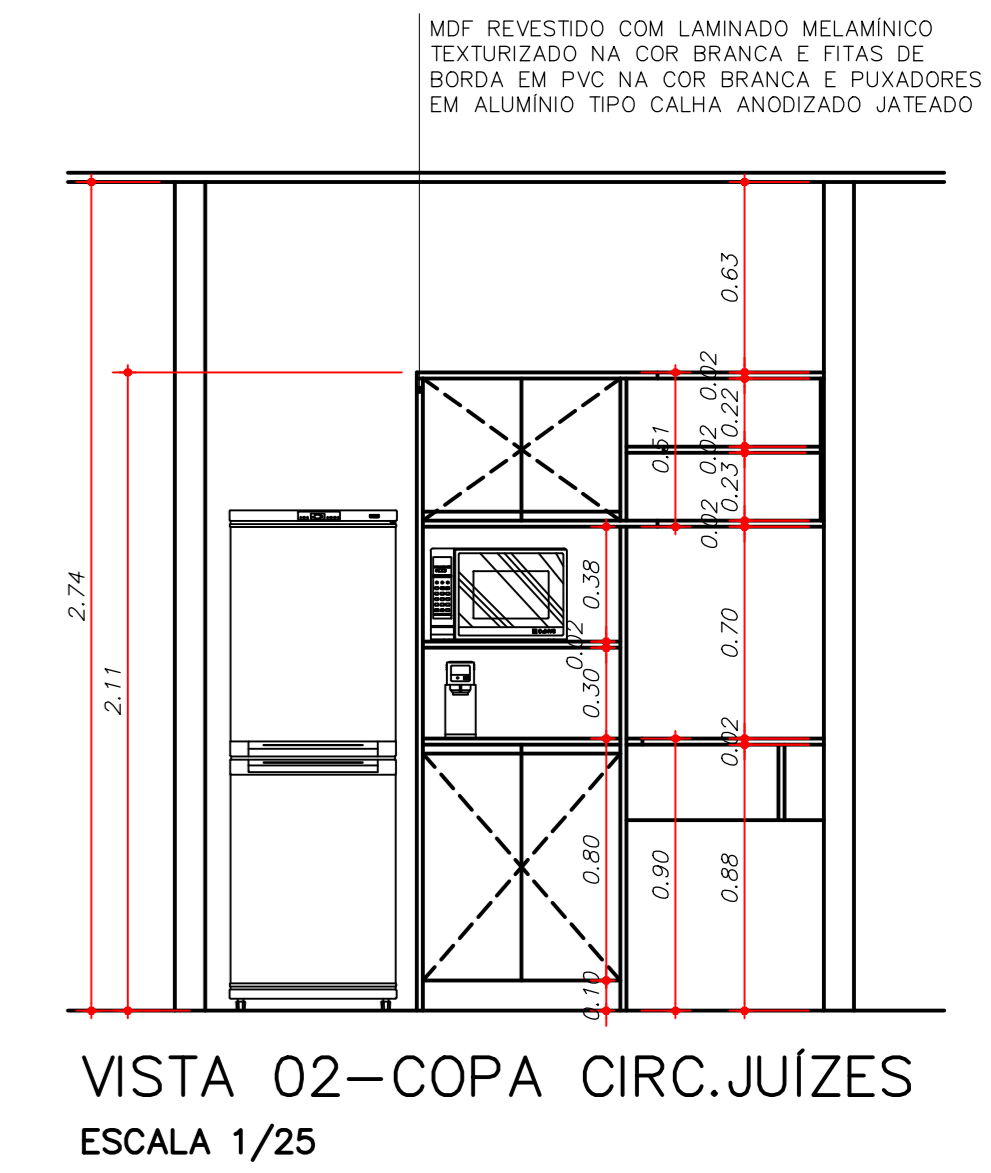

VISTA 02-COPA CIRC. JUIZES  
ESCALA 1/25

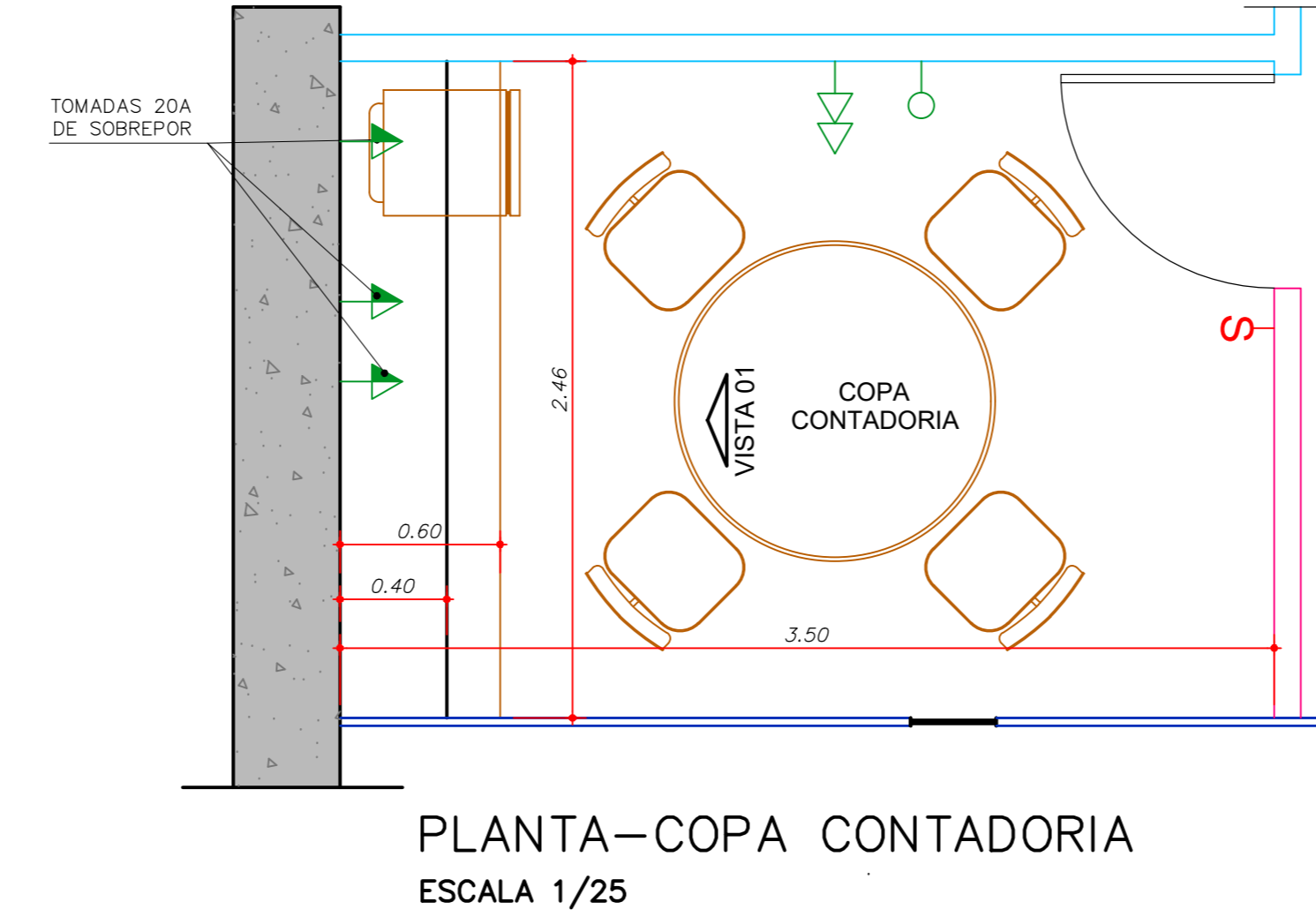

PLANTA-COPA CONTADORIA  
ESCALA 1/25

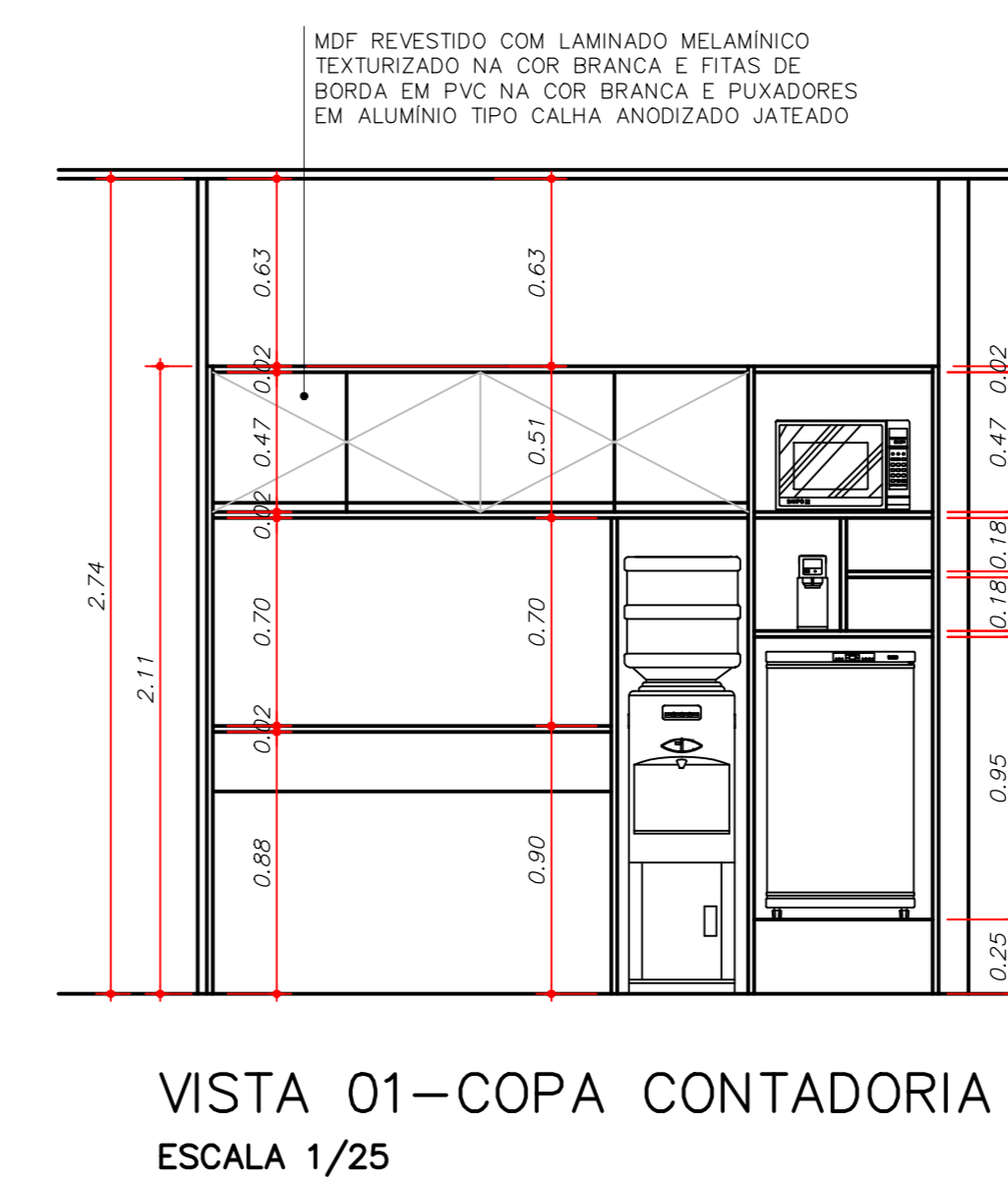

VISTA 01-COPA CONTADORIA  
ESCALA 1/25

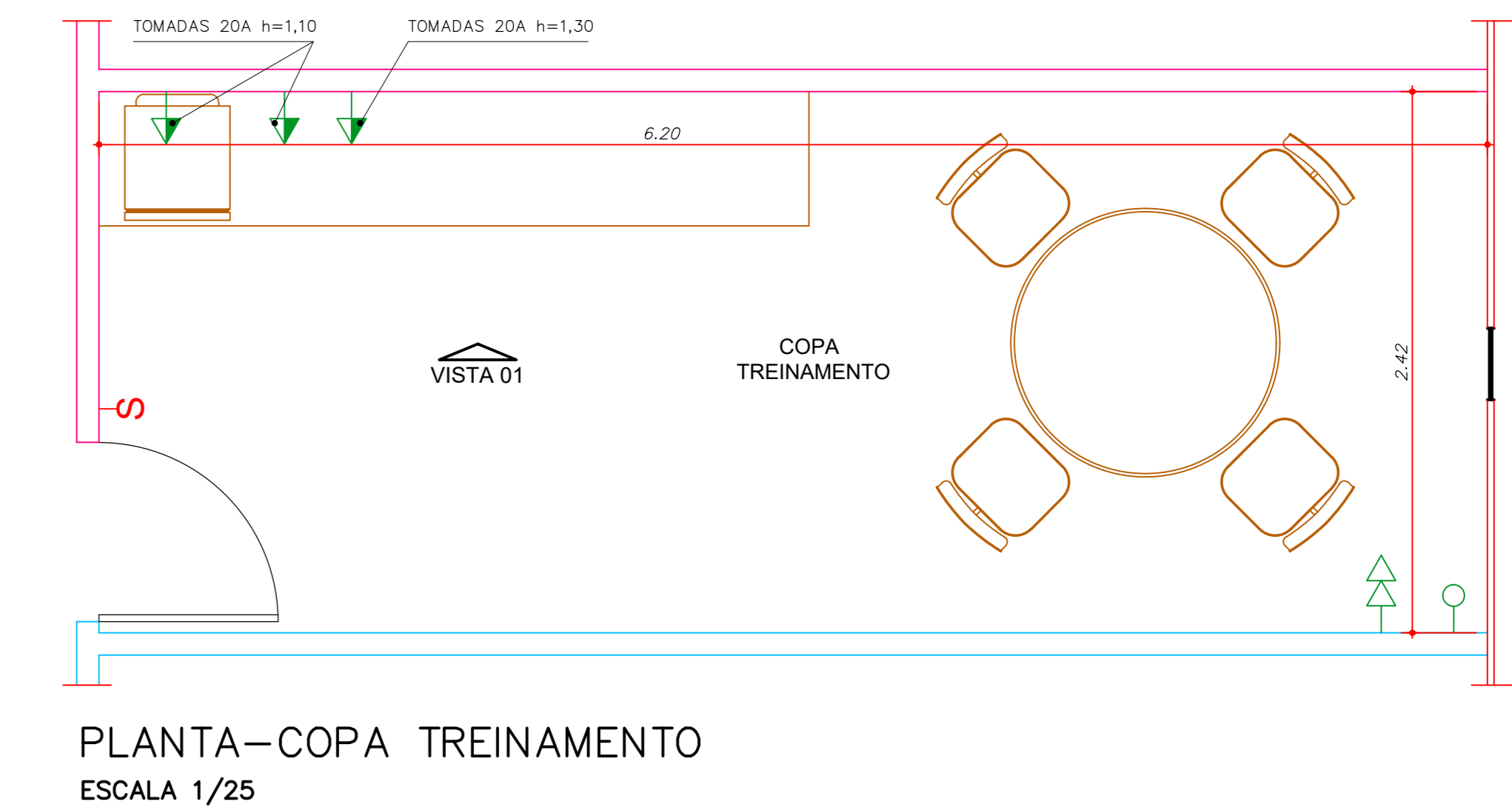

PLANTA-COPA TREINAMENTO  
ESCALA 1/25

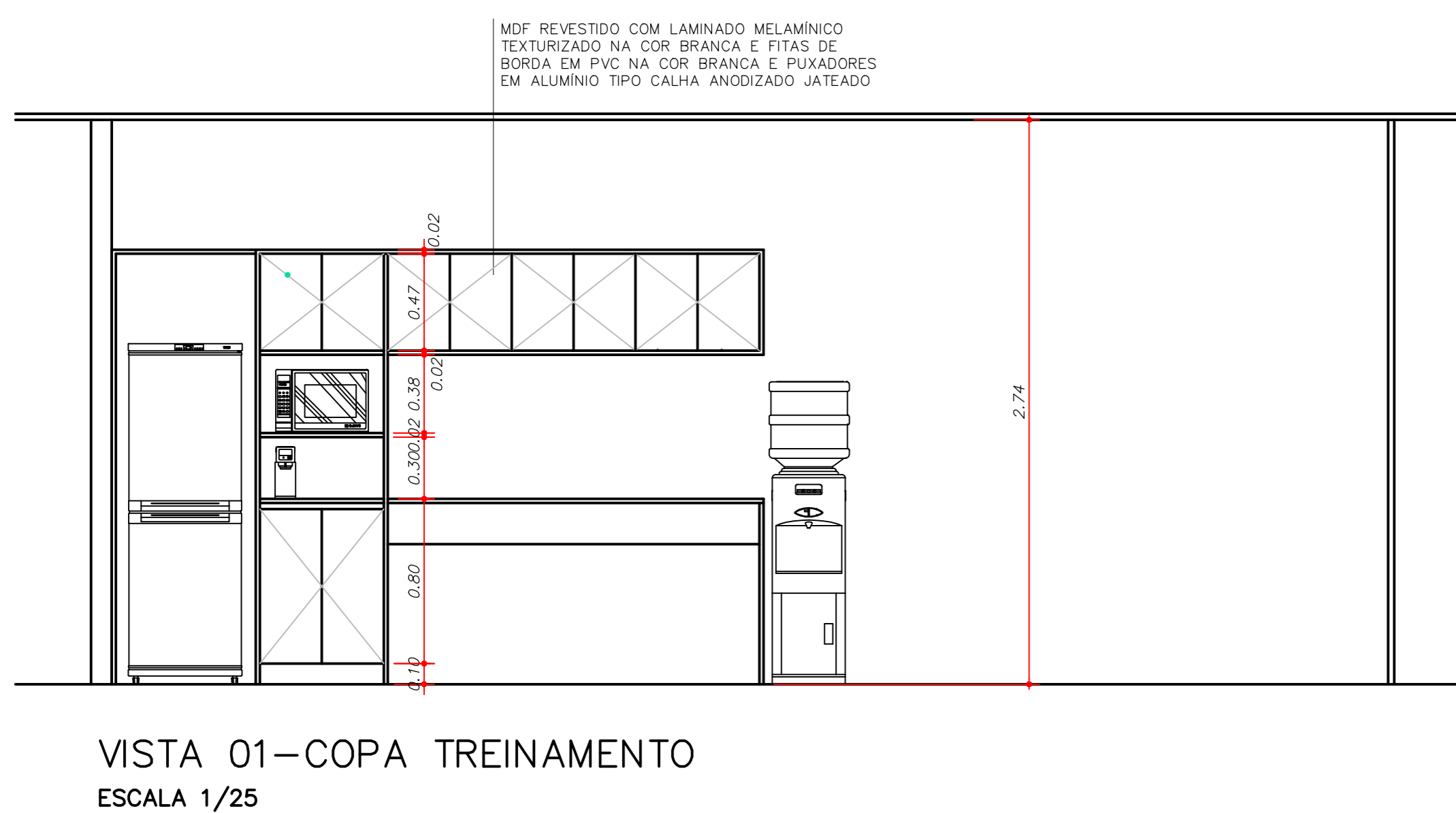

VISTA 01-COPA TREINAMENTO  
ESCALA 1/25

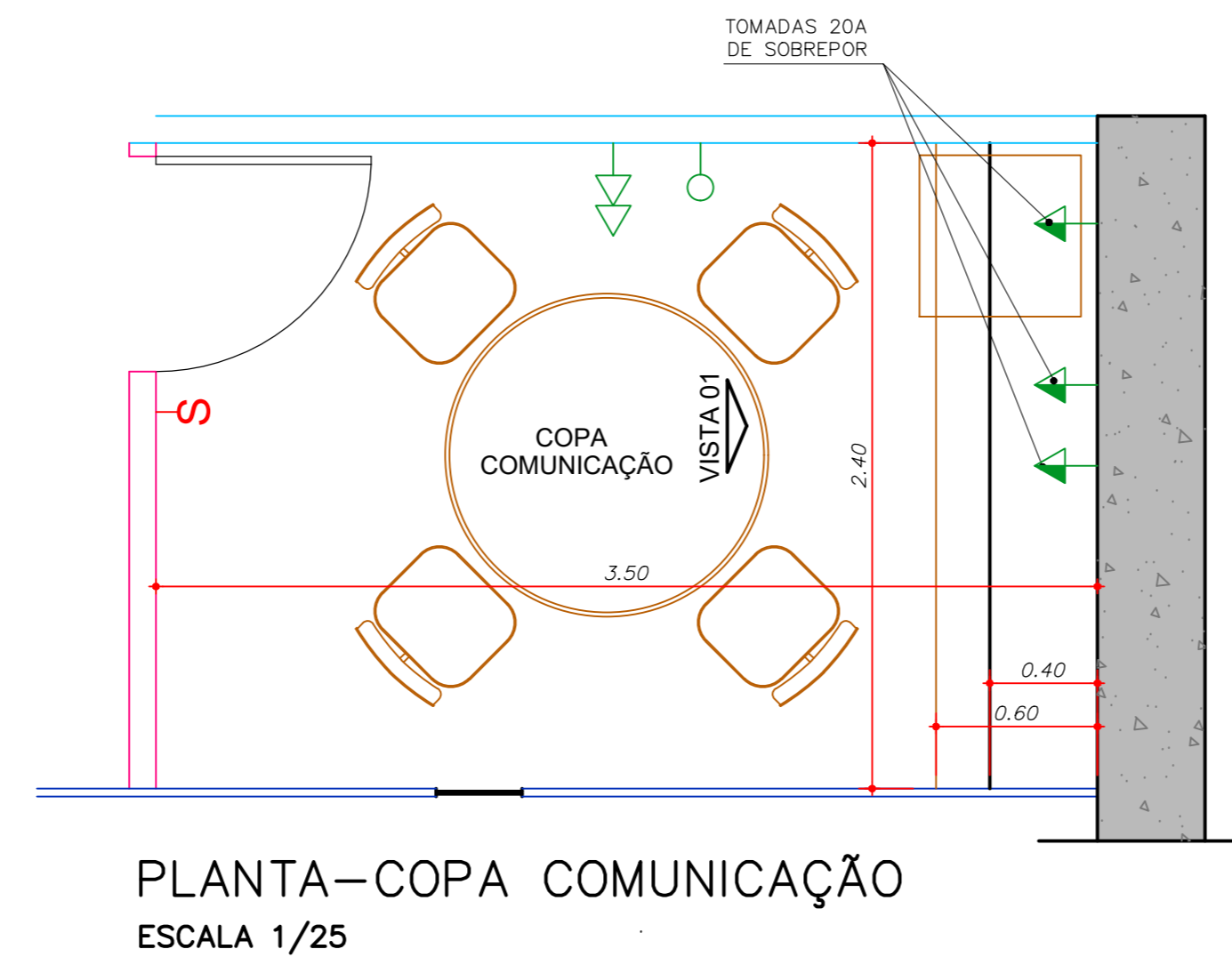

PLANTA-COPA COMUNICAÇÃO  
ESCALA 1/25

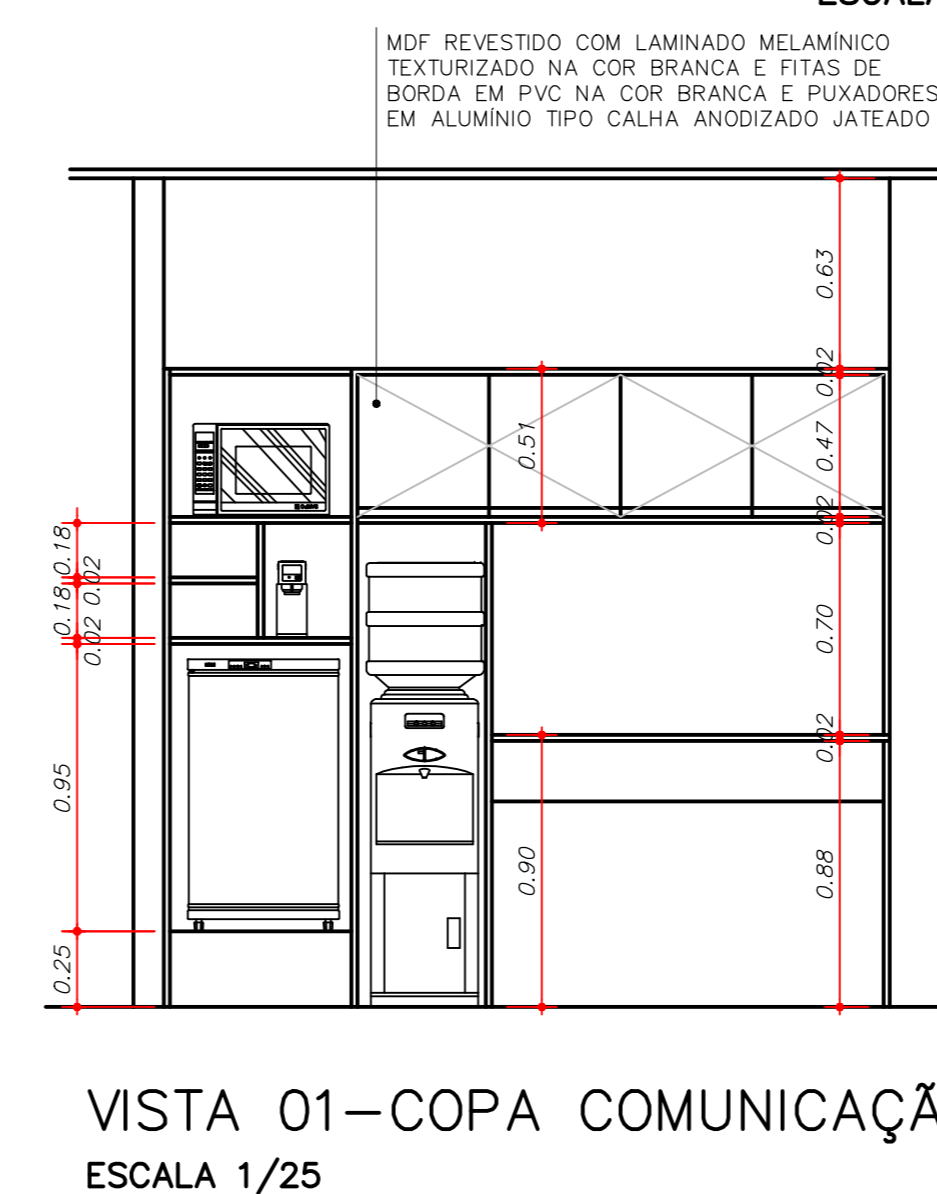

VISTA 01-COPA COMUNICAÇÃO  
ESCALA 1/25

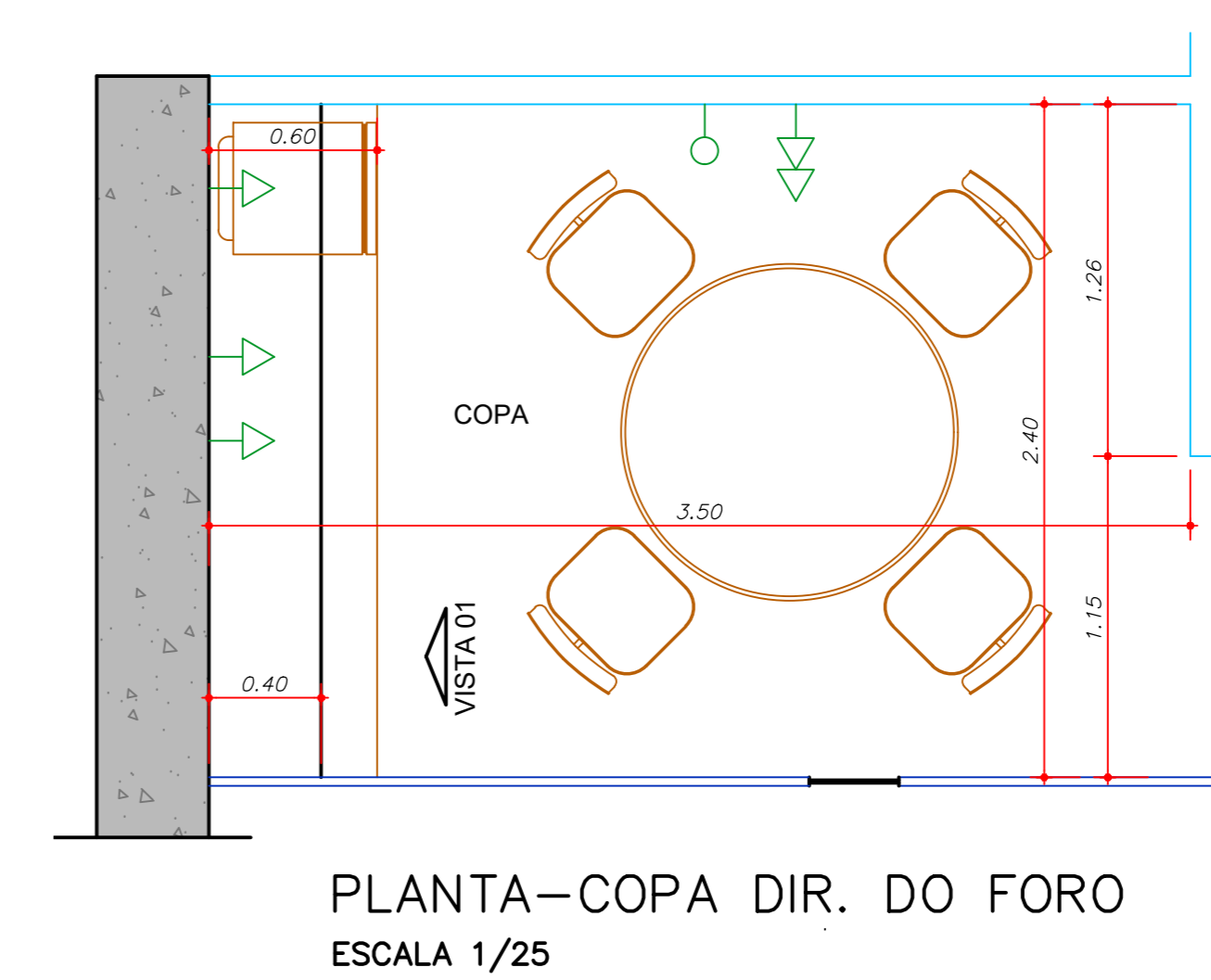

PLANTA-COPA DIR. DO FORO  
ESCALA 1/25

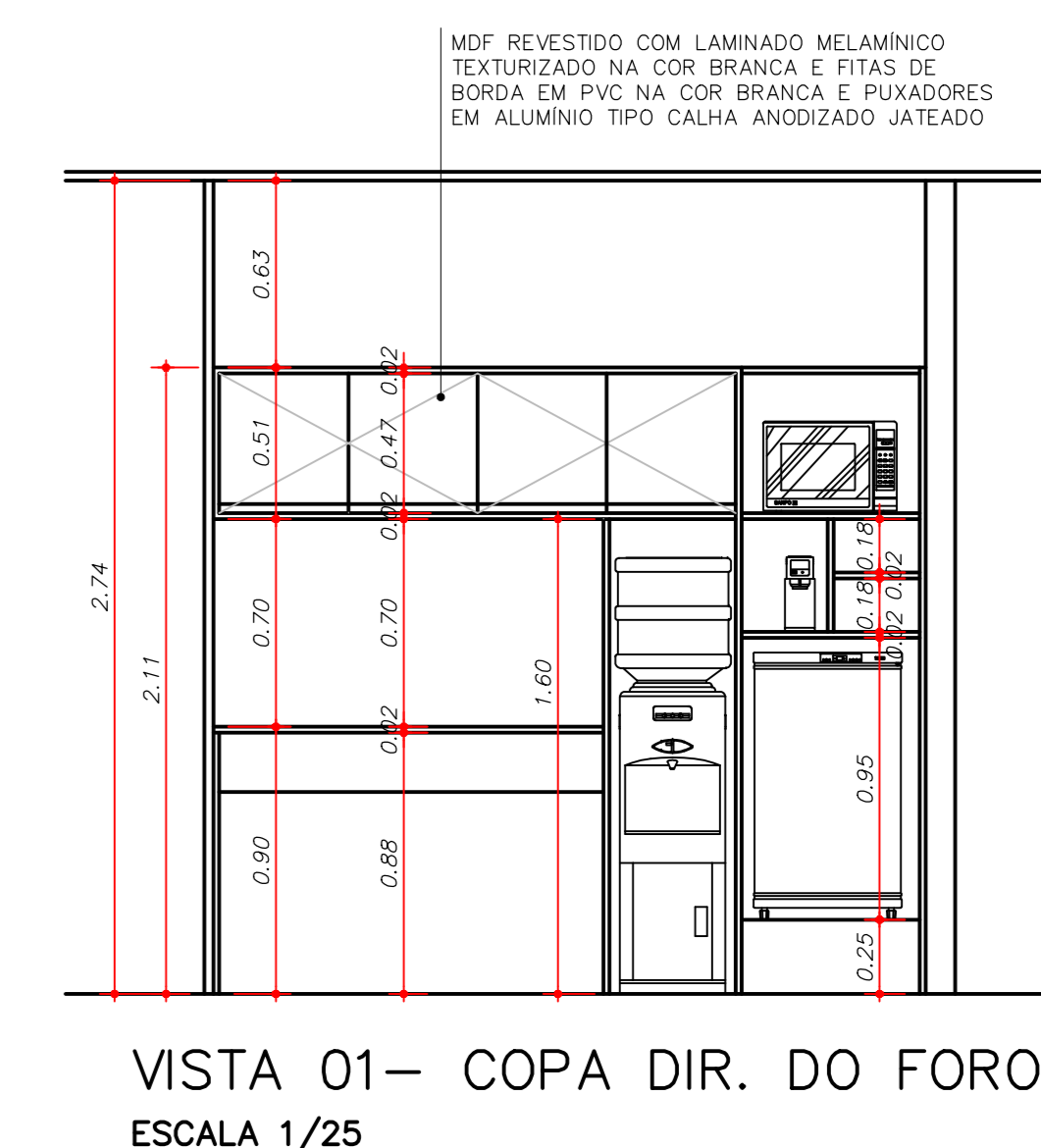

VISTA 01-COPA DIR. DO FORO  
ESCALA 1/25